



**CARVER**  
RESIDENTIAL  
Sales · Lettings · Property Management

Orchid Drive  
Heighington Village, Newton Aycliffe, DL5 6AN  
**Price £325,000**

House - Detached  
4 Bedroom/s  
2 Bathroom/s



Nestled in the charming village of Heighington, this stunning detached house on Orchid Drive is a true gem. Boasting four bedrooms, and two bathrooms, spacious living room, stunning kitchen/diner with a host of integrated appliances, also having French doors opening to the south facing rear garden, also having the benefit of a ground floor cloaks/WC and a handy utility room., this property offers ample space for a growing family or those who love to entertain.

As you step inside, you'll be greeted by a home that has been meticulously maintained to show house standards. The quality fixtures and fittings throughout the house add a touch of luxury to everyday living. Located in a small exclusive development, this property offers a sense of community while still providing privacy and tranquillity. The picturesque village location provides a peaceful retreat from the hustle and bustle of city life.

One of the standout features of this property is the south-facing rear garden. Imagine entertaining or spending time with family.

If you're looking for a home that combines elegance, comfort, and a touch of luxury, this property on Orchid Drive is the perfect choice. Don't miss the opportunity to make this house your dream home in the heart of the English countryside.







- EXCLUSIVE SMALL DEVELOPMENT
- PRESENTED TO SHOW HOUSE STANDARDS THROUGHOUT
- SET WITHIN THE PICTURESQUE VILLAGE OF HEIGHINGTON
- CORNER PLOT
- MATURE, ESTABLISHED SOUTH FACING REAR GARDEN

- BUILT TO A HIGH SPECIFICATION BY BELLWAY HOMES
- SUITED TO THE FAMILY BUYER
- FABULOUS OPEN PLAN KITCHEN/DINER WITH QUALITY INTERGRATED APPLIANCES
- DRIVE AND GARAGE
- INTERNAL VIEWING WILL IMPRESS THE DISCERNING BUYER

#### GENERAL INFORMATION:

Tenure: Freehold

Services: Gas central heating, mains electric, water and drainage.

Double glazing, Also having the remaining balance of a 10 year NHBC guarantee.

Local Authority: Darlington Borough Council (Tax Banding E)

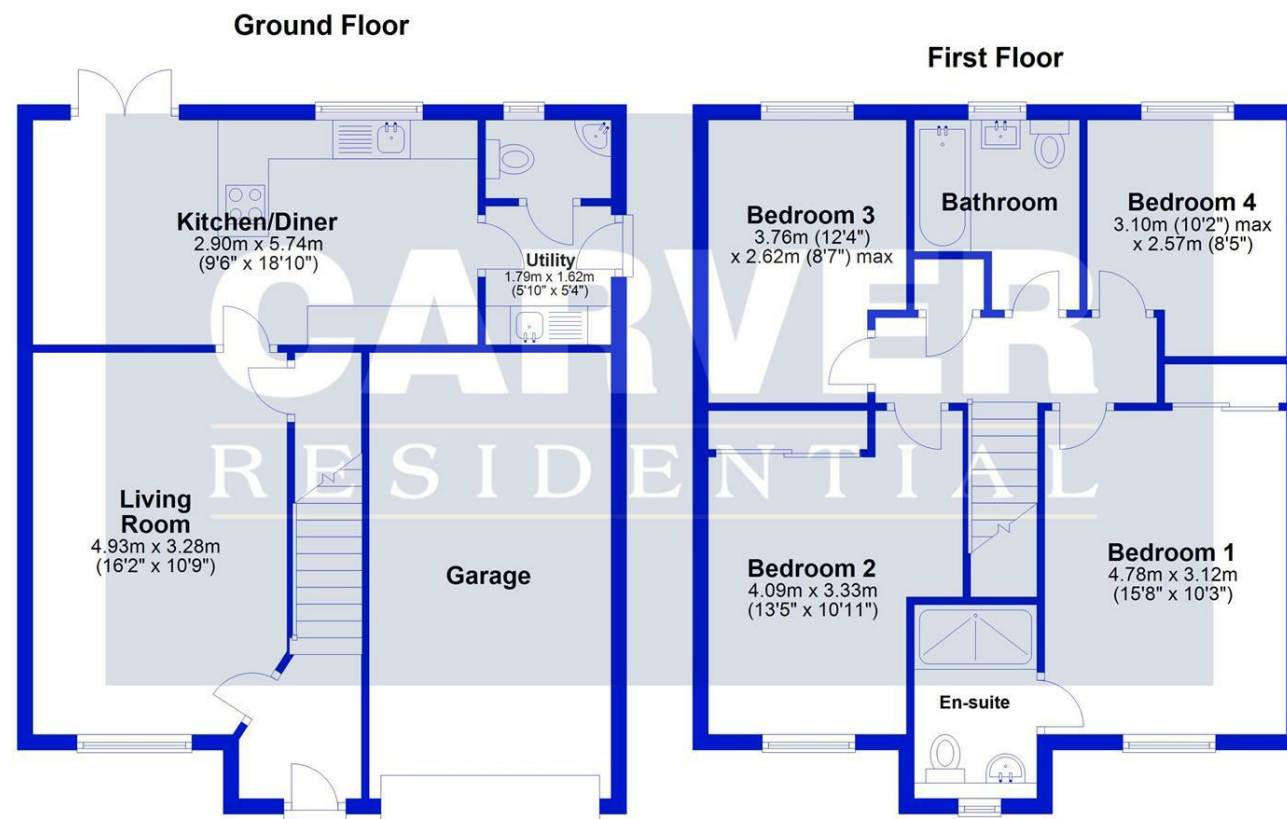

For identification purposes only. Not to scale.  
Plan produced using PlanUp.

Energy Efficiency Rating		
	Current	Potential
Very energy efficient - lower running costs		
(92 plus) <b>A</b>		<b>94</b>
(81-91) <b>B</b>	<b>83</b>	
(69-80) <b>C</b>		
(55-68) <b>D</b>		
(39-54) <b>E</b>		
(21-38) <b>F</b>		
(1-20) <b>G</b>		
Not energy efficient - higher running costs		
England & Wales		EU Directive 2002/91/EC

**We can search 1,000s of mortgages for you**

It could take just 15 minutes with one of our specialist advisers:  
Call: 01325 380088. Visit: Any of our Offices. Online: [www.mortgageadvicebureau.com/carver](http://www.mortgageadvicebureau.com/carver)



Your home may be repossessed if you do not keep up repayments on your mortgage.  
There will be a fee for mortgage advice. The actual amount you pay will depend upon your circumstances.  
The fee is up to 1% but a typical fee is 0.3% of the amount borrowed

MAB 6202



These particulars do not constitute any part of an offer or contract. None of the statements contained in these particulars are to be relied on as statements or representations of fact and any intending purchaser must satisfy himself by inspection or otherwise to the correctness of each of the statements contained in these particulars. The vendor does not make or give, and neither Nick & Gordon Carver Residential or Commercial, Nick & Gordon Carver, nor any person in their employment has any authority to make or give any representation or warranty whatever in relation to this property



**14 Duke Street, Darlington**  
**Co Durham, DL3 7AA**  
**01325 357807**  
[sales@carvergroup.co.uk](mailto:sales@carvergroup.co.uk)

**43 Dalton Way, Newton Aycliffe**  
**Co Durham DL5 4DJ**  
**01325 320676**  
[aycliffe@carvergroup.co.uk](mailto:aycliffe@carvergroup.co.uk)

**41 Market Place, Richmond**  
**North Yorkshire, DL10 4QL**  
**01748 825317**  
[richmond@carvergroup.co.uk](mailto:richmond@carvergroup.co.uk)

**219 High Street, Northallerton**  
**North Yorkshire DL7 8LW**  
**01609 777710**  
[northallerton@carvergroup.co.uk](mailto:northallerton@carvergroup.co.uk)

[www.carvergroup.co.uk](http://www.carvergroup.co.uk)